

WIND SPEED SENSOR WSP

SKU: WSP

Doc No: WSP-DS-EN-10

Introduction

WSP is the Wind Speed Sensor with carbon fiber material. Sensor with high weather resistance, high durability, corrosion resistance and water resistance.

- Weather resistant;
- High durability;
- High data transmission efficiency and reliable.

Typical applications

- Weather Station;
- Ship navigation;
- Aviation;
- Weather buoys;
- Wind turbines.

WIND SPEED SENSOR
WSP



WSP-H1.PNG

DIMENSION DRAWING OF SENSOR
(Unit: mm)

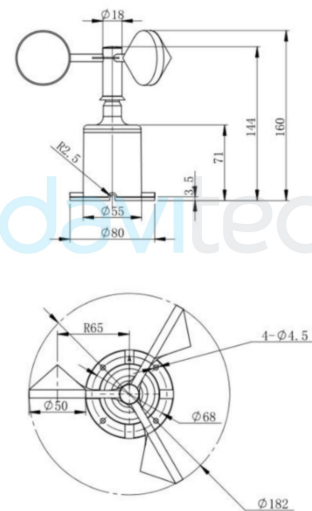

WSP-H2.PNG

Specification

Measure range	0-70m/s(Other can be custom made)
Start wind speed	0.2m/s
Response time	<0.5s
Resolution	0.1m/s
Accuracy	$\pm(0.2+0.03V)$ m/s, V means wind speed
Output	0..5VDC
Power supply	12..24VDC
Power consumption	≤ 0.3 W

Working temperature	-20~60°C
Working humidity	≤100%RH
Cable specifications	2m 3-wire system (analog signal)

Ordering Code

Item code	Descriptions
WSP-01-ANALOG	WIND SPEED SENSOR, 0-70 M/S, CARBON FIBER, 0-5VDC OUTPUT, 12-24VDC, WITH CABLE AND CONNECTOR
MBRTU-WSP-01	WIND SPEED SENSOR, CARBON FIBER CUPS, RS485/MODBUSRTU, 12-24VDC SUPPLY, 0-45M/S, IP65

 [Link for full datasheet:](#)

 [Link for manual:](#)

daviteq

Daviteq Technologies Inc



www.daviteq.com



info@daviteq.com

🕒 Revision #7

★ Created Mon, Apr 12, 2021 1:19 AM by [Kiệt Anh Nguyễn](#)

✎ Updated Mon, Apr 26, 2021 7:23 PM by [Lộc Vĩnh Nguyễn](#)