

# Sigfox Air Differential Pressure and Temperature Sensor WSSFC- APS-DT

SKU: WSSFC-APS-DT

**Doc No:** WSSFC-APS-DT-DS-EN-10

## Introduction

WSSFC-APS-DT is a Sigfox Air Differential Pressure & Temperature Sensor utilizes the advanced Piezo pressure sensor technology from Germany allows high accuracy, stable and ultra-low power consumption. Besides pressure measurement, the sensor also comes with a digital air temperature sensor. This special sensor is used to monitor the performance of the Fan Coil Unit of HVAC system. It can support all regions of Sigfox network in over the World, RC1, RC2, RC3, RC4, RC5, RC6, RC7.

- German Piezo Technology;
- Sigfox Ready;
- Plug & Play.

## Typical Applications

- 1. Air Filter Clogging Monitoring for FCU;
- 2. Monitor temperature of Air outlet of FCU;
- 3. Air Flow monitoring by Pitot tube;
- 4. Monitor Positive Pressure & Temperature of Clean Room;
- 5. Monitor Negative Pressure & Temperature of Clean Room;
- 6. ...

**SIGFOX** NODE DIFFERENTIAL PRESSURE WIRELESS SENSOR  
WSSFC-APS-DT



WSSFC-APS-DT-H1.PNG



**DIMENSION DRAWING OF WIRELESS SENSOR**  
(Unit: mm)

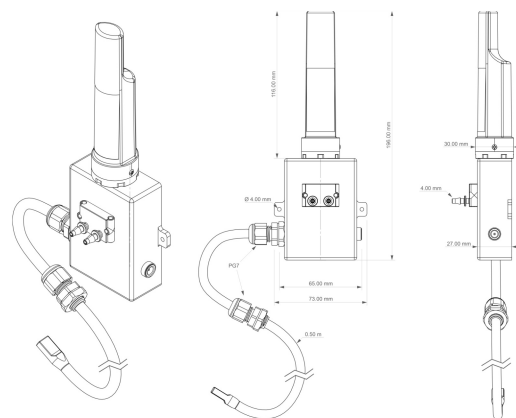

WSSFC-APS-DT-H2.PNG

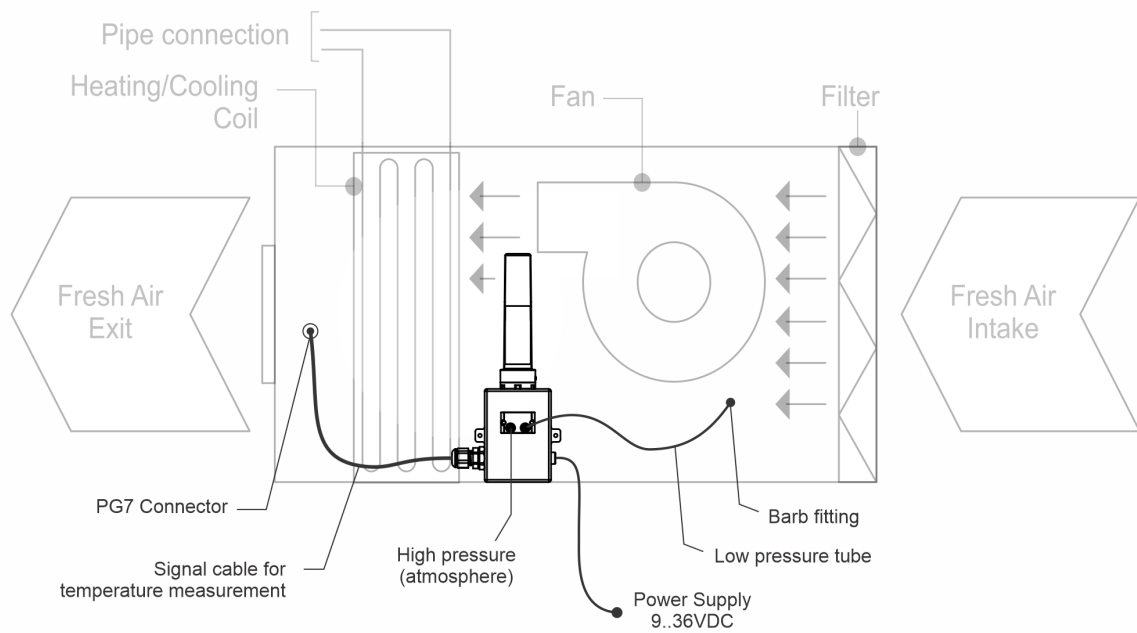

## Specification

SENSOR SPECIFICATION	
<b>Pressure Technology</b>	Advanced CMOS technology from Germany
Measuring range & accuracy	+/-125 KPa, 3% reading
Zero accuracy & repeatability	0.08 Pa, 0.04 Pa
Temperature drift & Offset stability	< 0.5% reading per 10 oC, < 0.05 Pa/year
Measurable Gases	AIR, O2, N2 (No condensation)
Working temperature	-20 .. + 85 oC
Wetted parts	PBT, glass (silicon nitride, silicon oxide), silicon, gold, FR4, silicone as static sealing, epoxy, copper alloy, lead-free solder
Process connection	Barb fittings for gas tube 6x4mm, come with 2 x 1m 6x4mm PE tube and 2 brass barb fitting G1/4"
<b>Temperature Sensor</b>	Digital type, factory calibrated, IP67, immersible to ice-water for quick validation
Measuring range	-35 .. + 70 oC
Accuracy & Resolution	+/- 0.5oC, 0.125oC
Material	PA plastic with PVC cable, 500mm length with PG7 cable gland for mounting
SIGFOX SPECIFICATION	
Sigfox zones	select RC2-RC3-RC4-RC5 or RC1-RC6-RC7
Antenna	Internal Antenna 2 dbi

Configuration	via offline USB cable (PC software is supplied at free)
Power supply	9..36VDC, max 300mA, 9mm DC Jack, 220VAC Power adapter EU plug is supplied as standard
RF Module complies to	CE, FCC, ARIB
Dimensions	H200xW50xD30
Net-weight	150 grams
Housing	ABS+Polycarbonate, IP54
Mounting	Wall mount bracket by 02 x screw M4

## Ordering Code

Item code	Descriptions
WSSFC-APS-DT-125-9	SIGFOX AIR DIFFERENTIAL PRESSURE & TEMPERATURE SENSOR, 0-125 PA, -20 TO +70 oC PROCESS, INTERNAL ANTENNA, 9..36VDC SUPPLY, IP54, RC2-RC3-RC4-RC5 ZONES
WSSFC-APS-DT-125-8	SIGFOX AIR DIFFERENTIAL PRESSURE & TEMPERATURE SENSOR, 0-125 PA, -20 TO +70 oC PROCESS, INTERNAL ANTENNA, 9..36VDC SUPPLY, IP54, RC1-RC6-RC7 ZONES

 [Link for full datasheet:](#)

 [Link for manual:](#)

**daviteq**

Daviteq Technologies Inc



[www.daviteq.com](http://www.daviteq.com)



[info@daviteq.com](mailto:info@daviteq.com)

🔄 Revision #5

★ Created Thu, Oct 1, 2020 12:16 AM by [Lộc Vĩnh Nguyễn](#)

✎ Updated Mon, Oct 5, 2020 12:50 AM by [Kiệt Anh Nguyễn](#)